



R-31 S

Northwest & Luxury Editions



Specifications

Length overall (rigged)	34' 10" 10.62 m
Draft	30" 0.76 m
Beam	10' 3.05 m
Bridge clearance (mast down)	10' 3.05 m
Bridge clearance (mast up)	13' 10" 4.22 m
Height on trailer (mast down, estimated)	13' 6" 4.11 m
Length on trailer (estimated)41' 12.5 m
Fuel capacity	180 US gal 681.4 L
Water capacity	60 US gal 227.1 L
Hot water capacity	11 US gal 41.6 L
Waste capacity	40 US gal 151.4 L
Weight, dry	12,000 lbs 5,443 kg
Engine	Volvo D4 320 HP common rail diesel engine

The R-31 S shares many of the features and qualities of her smaller sisterships but some notable additions to this larger model make her ideal for extended cruising while still being a trailerable trawler. The builders at Ranger Tugs equipped the foredeck with seating and a table that can be raised or lowered depending on whether the boat is under way or at anchor or dock for entertaining. In addition to the foredeck seating, the R-31 boasts a larger cockpit area with wrap-around seating utilizing seats that fold out of the gunwale. When not entertaining, seats are folded leaving the cockpit unencumbered.

The interior layout of the R-31 S features two staterooms—one large island berth forward with en suite head and a midship berth and day head. Those who are familiar with Ranger Tugs models will recognize the galley layout and helm station that maximize interior space. A starboard side door provides easy access from the helm to the side decks so crew can get to the bow for line handling.

Like all Ranger Tugs, the R-31 S comes essentially turnkey with standard features and equipment intended to make her owner's experience hassle-free and allow for ease of handling and comfort under way. Standard equipment includes bow and stern thrusters and a Volvo D4 320 HP engine that achieves a 16 knot cruise speed.

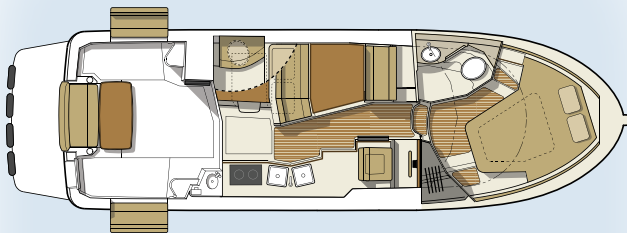

Model Features

Garmin 8616xsv Chartplotter with xHD Radar

A full navigation package from Garmin including the large 8616xsv GPS chartplotter with sonar and xHD radar is standard equipment on the R-31 S. Easily monitor fuel flow, engine data, bottom conditions, GPS location, tides and much more.

Multifunction Seating

Innovative, one of a kind, expanding gunwale seats transform the cockpit into a social area, with seating for six+ and a beautiful wood table. True to Ranger Tug's DNA, all the seating in the R-31 S maximizes available space and usability.

Full Galley

The full galley aboard the R-31 S is a chef's dream, featuring a propane stove and oven with broiler, double basin sink with pull-out rinse faucet, cutting board, silverware and utensil drawers, large cabinets, refrigerator/freezer combo, 110v outlet, wine/water cooler and microwave.

Solar Panel

The included solar panel helps to keep your batteries charged while you're boating off-grid. Now you can go further and stay longer without the need for shore power or a generator.

Bow and Stern Thrusters

Included bow and stern thrusters make docking and close quarters maneuvering a breeze. The wireless thruster remote allows for additional flexibility and control.

Helm Door

The R-31 S features a full-size helm door allowing convenient access to the bow and easy fender and line handling.

Midship Stateroom

The midship stateroom aboard the R-31 S is large enough to comfortably sleep two and features a day head as well as a hanging rack for additional storage.

Standard Features

Performance

320 HP Volvo D4 diesel inboard

Electric trim tabs

Bow and stern thrusters

Thruster wireless remote

Trailerable - 10' beam

Accommodations & Interior Comfort

Air conditioning (Luxury edition)

Cabin drink holders, 4

Cabin heater (engine)

Curtains for privacy

Dinette (seats 5) converts to bed

Fully enclosed head

Fusion stereo system (multi-zone)

Hatches, pilothouse roof,
solar reflective, 4

Hatches, stateroom, 1

**Heater (NW: diesel,
Luxury: AC reverse cycle)**

Indirect cabin lighting

Island bed

LED lighting

**Electric marine toilet
w/ holding tank, pump out**

Memory foam mattress

Midship stateroom

Opening portlights, 2

Private forward stateroom

Shower with enclosure

Storage under mattress

TV in salon

TV in stateroom

Deck Features

**Anchor package, 22 lb, 50' chain,
200' line**

Bow lounge seating, 2

EVA foam traction decking

Forward line storage

Bolded items: High value features included in the price of the Ranger Tugs R-31 S.
Other manufacturers oftentimes list these features as options with an additional cost.

Rod holders, 2

Sport racks, stainless steel

Swimming ladder, stainless steel

Swim step, with built-in fenders

Washdown system

Windlass, bow and helm controls

Cockpit

**Cockpit cover, hard-top
w/ hatches and lights**

Cockpit drink holders, 5

Cockpit refrigerator

Cockpit seating, 6+

Cockpit sink

Cockpit table

**Downrigger plugs and pads
(NW edition)**

Fold-out gunwale seating

Powered engine hatch

Transom entry door for boarding

Helm

AIS receiving

Color engine display

Digital fuel flow data

**Electronic shift and throttle control,
single lever**

Garmin autopilot

**Garmin 8616xsv navigation system
w/ GPS and sonar**

Garmin radar, xHD

Helm drink holder

Sliding helm door

USB charging ports

Windshield wipers, 4

Galley

Cutting board

Galley cabinets, 4

Galley drawers, 4

Microwave

Offset galley for clear walkway

Oven, propane

Refrigerator/freezer

**Sink with hot and cold water, double
basin, with pull-out rinse faucet**

Stove top, propane

Wine/water cooler

Mechanical & Electrical

AC electrical panel

Batteries

Battery charger

DC electrical panel

Generator, diesel (Luxury edition)

Inverter

Macerator discharge

Shore power cord(s)

Solar panel, 175w with controller

Underwater lights

Safety

Carbon monoxide detectors

Courtesy lights

Electric horn

Illuminated compass

Navigation lights

**Safety kit: fenders, lines, flares,
fire ext, first aid kit, life jackets,
boat hook**

Spotlight with remote

Swim platform rails

VHF radio, DSC capable

Window defrosters

Construction

Bonded electrical system

Foam-filled fiberglass stringer grid system

Premium hull color, Midnight Blue

Seawater strainer(s)

Self bailing cockpit

Stainless steel cleats, rails, hardware

Vinylester barrier coat

Ranger Tugs R-31 S Packages

The Ranger Tugs R-31 CB is sold fully equipped and ready to cruise with an expansive selection of premium features and outfitted in one of two packages:

Northwest Edition

Most commonly used in colder climates where air conditioning would not be necessary. Equipped with diesel forced air heater, and downrigger plugs & pads.

Luxury Edition

Most commonly used in warmer climates where air conditioning is a must. Equipped with air conditioning/reverse cycle heating, and diesel generator w/ sound shield.

Scan Code for Pricing and Specifications



Options, freight & taxes extra.
Prices, specifications, equipment, and options may change without notice. Information on this sheet should not be used for navigation. ⁰³²³



Additional Factory Options

- Aft cockpit sun and sunset shades
- Aft steering, second station with electronic controls
- Carpet runner, interior
- Cockpit freezer (in lieu of cockpit refrigerator)
- Dinghy, inflatable RIB 290 CSM hypalon with Weaver davits, stand-off & winch
- Factory Delivery Experience
- Garmin GXM Weather Antenna
- Hull color upgrade (from standard Midnight Blue)
- Low speed module
- Volvo Five Year Extended Coverage



47 37th st NE
Auburn, WA, 98002
253-839-5213

www.RangerTugs.com

