

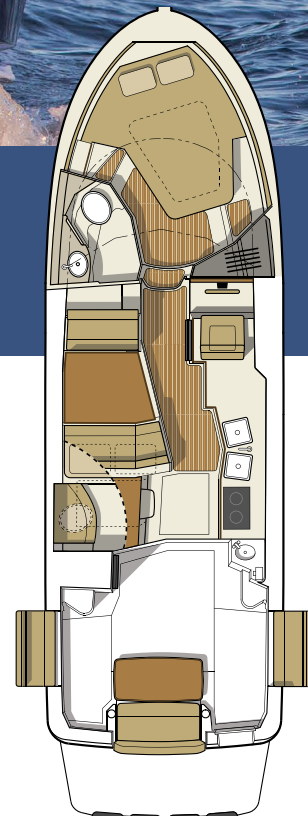

R-31 S



The R-31 S is the largest in the trailerable Ranger Tugs fleet making her ideal for extended cruising and entertaining. She comes standard with bow and stern thrusters for ease of handling. The foredeck features seating and a table that can be raised for entertaining and lowered while underway. The generous cockpit also features wraparound seating utilizing hidden seats that fold out of the gunwale. The interior layout of the R-31 S features two staterooms - one large island berth forward with en suite head and a midship berth with day head. A starboard side door provides easy access from the helm to the side decks for line handling. Like all Ranger Tugs, the R-31 S comes essentially turn-key with standard features and equipment intended to make her owner's experience hassle-free and allow for ease of handling and comfort under way.



Specifications

Length (molded)	31' 2"	9.5 m
Length (w/swim step)	35' 2"	10.72 m
Beam	10'	3.05 m
Draft	28"	.71 m
Bridge clearance (mast up)	14' 0"	4.27 m
Bridge clearance (mast down)	9' 8"	2.95 m
Height on trailer	13' 1"	3.99 m
Length on trailer	41' 8"	12.70 m
Fuel capacity	180 US Gal	681.37 L
Water capacity	80 US Gal	302.83 L
Hot water	11 US Gal	41.64 L
Holding tank capacity	40 US Gal	151.42 L
Weight, Dry	11,000 lbs	4,989.52 kg
Engine	Volvo D4 300 HP diesel common rail electronic engine	



Ranger Tugs R-31 S Value Package **FACTORY DIRECT PRICING**

All Ranger 31 models are sold **fully equipped** and **ready-to-cruise**. There are two packages to choose from, the Luxury Edition with a diesel generator and air conditioning or the Northwest Edition with a diesel forced air furnace and downrigger plugs and pads.

Northwest Edition Included Features:

- AIS 300
- Anchor Package 22# anchor, 50' HT chain, 200' line
- AGM batteries
- Autopilot, dual station, Garmin w/ remote
- **Diesel heater, forced air furnace**
- **Downrigger plugs & pads**
- LED lights
- Macerator discharge
- Navigation package, Garmin 7616, 4kw HD radar dome, GPS ant., depth/ff
- Swim platform rails
- Safety kit
- Solar panel, 145 watt w/control panel
- Thruster wireless remote
- Underwater lights

FULLY EQUIPPED, READY-TO-CRUISE FROM:

\$309,937.00*

Luxury Edition Included Features:

- AIS 300
- **Air conditioning/ rev cycle heat**
- Anchor Package 22# anchor, 50' HT chain, 200' line
- AGM batteries
- Autopilot, dual station, Garmin w/ remote
- **Generator, diesel w/sound shield**
- LED lights
- Macerator discharge
- Navigation package, Garmin 7616, 4kw HD radar dome, GPS ant., depth/ff
- Swim platform rails
- Safety kit
- Solar panel, 145 watt w/control panel
- Thruster wireless remote
- Underwater lights

FULLY EQUIPPED, READY-TO-CRUISE FROM:

\$324,937.00*

Standard Features

Performance

- Volvo 300 HP D4 common rail diesel engine
- Bow and stern thrusters
- Full color electronic engine control display
- Single lever, electronic shift and throttle control
- Trim tabs



Boater Features

- Anchor locker, S.S. self-launching bow roller through stem
- Electrical panels AC/DC
- Folding S.S. mast for trailering
- Fuel flow data display
- Pilothouse door, stbd side, sliding, locking
- Powered engine hatch
- Rod holders
- Sea water strainers
- Sport racks
- Swim step w/ built-in fenders and swim ladder
- Wash down system, raw water
- Windlass with bow and helm controls



Convenience

- Cabin Heater (engine)
- Cockpit convenience center, sink
- Cockpit table and seating
- Cowl vent (forward cabin ventilation)
- Dinette, salon, converts to bed, high/low table, sleeps 2
- Double wide, reversible companion seat

- Enclosed head, vessel sink, shower with enclosure
- Foredeck seat and table
- Forward deck hatch, opening translucent
- Hatches (5), pilothouse roof, opening with screens
- Holding tank level monitor
- Inverter, 2000w, PSW
- Island bed, master stateroom (memory foam)
- Lounge seating, dinette converts to lounge for reading
- Marine heads (2), fore and aft, electric, holding tank, deck pump out
- Midship stateroom, double berth, privacy door, head
- Outlets 110V (5)
- Microwave
- Portlights, brass, opening with hooks
- Power outlets, 12V port and stbd, master state room, midship
- Refrigerator/freezer, galley, 12V
- Refrigerator/freezer, cockpit, 12V
- Sinks (4), fresh water system w/demand pump, H and C
- Storage lockers (6), cabin, w/teak louvered doors
- Stove/oven, propane, two burner, includes propane box, (2) tanks
- Transom door for easy boarding
- Visor/drip rails, fwd and side windows
- Water tank level monitor (fresh)
- Windshield wipers (4) pantographic
- Wine/water cooler, 12V, (6) bottle

Safety

- Diesel power
- Co Monitors (2), 12V
- Courtesy lights, cockpit entry steps, swim step, and walkways

- Dual trumpet electric horn
- Illuminated compass
- Navigation lights, with light boards
- Spotlight w/remote control
- VHF radio, Garmin with antenna, DSC capable
- Window defrosters

Entertainment

- Entertainment center, master stateroom with 22" TV/DVD
- Entertainment center, salon with 19" overhead TV/DVD
- Fusion stereo, (6) speakers, Bluetooth (controllable through Garmin GPS)

Construction

- Bonded electrical system
- Bronze rudder, propeller, and thru-hulls
- Fiberglass cockpit liner, self-bailing w/non-skid
- Fiberglass stringer
- S.S. cleats, rails, ext. hardware
- Sunbrella fabrics
- Teak and Holly cabin sole
- Vinylester barrier coat (hull)



Additional Factory Options

Aft cockpit sun and sunset shades	\$1,500
Aft steering, second station with electronic controls	\$4,970
Aluminum triple axle trailer, electric/hydraulic brakes, spare tire w/bracket	\$15,600
Carpet runner, Teak and Holly, cockpit	\$720
Carpet runner, Teak and Holly, interior	\$620
Cockpit ice maker (in lieu of cockpit refrigerator)	\$470
Cockpit sun shade with sunset shade	\$1,499
Dinghy, inflatable RIB 290 CSM hypalon with Weaver davits, stand-off & winch	\$5,125
Dinghy motor, 2.5 HP, 4-stroke, storage bracket	\$1,115
Dinghy motor, 6 HP, 4-stroke, storage bracket	\$1,945
Dinghy motor, 9.9 HP, 4-stroke, storage bracket	\$2,935
Factory Delivery Experience	\$2,500
Garmin GXM 52 XM/weather antenna	\$870
International option, 240v	\$900
Low speed module	\$2,000

*Options, freight & taxes extra
Prices, specifications, equipment and options may change without notice. 0818



25802 Pacific Highway South
Kent, WA 98032
Phone 253-839-5213

www.RangerTugs.com

